

# International Joint Degree Master's Program in Agro-Biomedical Science in Food and Health, Graduate School of Comprehensive Human Sciences, University of Tsukuba

## Application Guidelines for September 2024 Enrollment (August Selection Process)

**For applicants who wish to choose a faculty member  
of the University of Tsukuba as their supervisor**

### Important Notice

Travel to the University of Bordeaux (France) or the National Taiwan University (Taiwan) may not be possible due to the ever-changing COVID-19 situations in these universities or countries. In such cases, students will take online or on-demand courses provided by the University of Bordeaux and the National Taiwan University while staying in Japan.

“Food and Health” is a global issue, extending beyond national borders. With the aim to develop highly specialized professionals who can both appreciate “Food and Health” and be active internationally, the University of Tsukuba established the International Joint Degree Master's Program in Agro-Biomedical Science in Food and Health in cooperation with the University of Bordeaux (France) and National Taiwan University (Taiwan). Students of this program attend lectures and receive research guidance for at least a semester at each university and will receive a “Master of Agro-Biomedical Science in Food and Health” degree upon graduation, jointly awarded by the three universities. For more details, please visit our website (<http://www.gip.tsukuba.ac.jp/english/index.html>).

If you wish to enroll in this program, please read the application guidelines below before applying.

Those who wish to choose a faculty member of the University of Bordeaux or National Taiwan University as their supervisor cannot apply through these guidelines.

### Key Dates

Application period	July 7, 2023 to July 21, 2023
Oral examination	August 25, 2023 In case of high demand, we will conduct another examination on August 28, 2023.
Announcement of admission results	September 14, 2023
Date of enrollment	September 1, 2024

### 1. Prospective Students

This program seeks students with a background in medical or agro-biological resources science and a cooperative spirit who are strongly determined to innovate and contribute to the future of society and Mankind by overcoming national and academic boundaries to assertively tackle global-scale issues related to the fields of health and food.

### 2. Number of Students to be Admitted

3 students

### 3. Eligibility for Application

Eligible applicants of the Graduate School must meet one of the following requirements, in accordance

with the provisions of the School Education Act:

(A) No eligibility screening is required for the following individuals:

- Individuals who have graduated or who will graduate from a Japanese four-year university by August 2024.
- Individuals who have graduated from a university outside Japan that implements 16 or more years of school curriculum, up to university graduation, and earned a bachelor's degree by August 2024.
- Others (for applicants who do not fall into the above 2 categories)

(B) Eligibility screening is required for the following individuals:

- Individuals who have graduated from a junior college or high school
- Individuals who have graduated from a vocational school or miscellaneous educational institution
- Individuals who have graduated from a university in a foreign country that implements less than 16 years of school curriculum
- Others (for applicants who do not fall into the above 3 categories)

Individuals expected to undergo eligibility screening must contact the Office of the International Joint Degree Master's Program in Agro-Biomedical Science in Food and Health (see below, **13. Contact Us**) in advance. The required screening documents **must** be submitted by **July 3, 2023**.

For eligibility details and the documents required for screening, visit the university website:

[Graduate Eligibility for Admission - University of Tsukuba](#)

#### **4. Notices Before Applying**

It is recommended, but not required, to contact your prospective supervisor in advance.

A minimum score of 61 for TOEFL iBT, 600 for TOEIC, or 5.0 for IELTS is required as this program conducts all lectures and research guidance in English.

Scores from the TOEFL iBT Home Edition test can be accepted as certification of English proficiency.

#### **5. Examination Fee**

JPY 30,000 (except for Government-Sponsored [Japanese Government *Monbukagakusho* Scholarship] foreign students)

1. Payment Period: July 7, 2023 – July 21, 2023
2. Procedure: Payment must be made by a credit card or at a convenience store (for details, refer to the attachment.)

#### **6. Documents to be Submitted**

We will review applicant contents and bachelor's program results, purposes and plans of study in this program, career plans after graduation, and English proficiency. We will also evaluate the applicant's background and determination to solve global issues concerning "food and health" as well as aptitude for international and interdisciplinary study based on the documents below.

All documents from (1) to (12) must be prepared in English. If you are submitting in a language other than English under unavoidable circumstances, attach the English translation along with the original.

##### **(1) Application Form (Official Form)**

Attach the "Certificate of Payment" issued by a convenience store or a credit card to the designated

column of the application form.

**(2) Curriculum Vitae/Employment Record (Official Form)**

Submission of the Employment Record is required only for applicants who have a work history.

**(3) Reference Card/Photo Card (Official Form)**

Paste an identical photograph on both cards.

**(4) Essay (Official Form)**

Fill in your motivation and background for entrance to this program and your research plan during the program (including purpose and plan of study plus career plan) within 500 words in English.

The font must be Times New Roman and the size 11 points. Any alteration in style and/or insertion of figures and graphs will cause the essay to be rejected.

**(5) (Expected) Graduation Certificate/Academic Transcript**

Submit a graduation certificate (or an official document certifying that you are expected to graduate) issued by a university or other type of educational institution that awarded or will award you a bachelor's degree.

If any subject mentioned in the transcript has been certified because of a transfer, please also submit the academic transcript from the previous school, etc., along with the latest transfer.

If your GPA is not mentioned in the transcript and you possess other GPA certification, please submit this documentation as well.

\* Submit only original documents with an official seal. When submitting copies of certificates that cannot be reissued or for other reasons, a copy may be submitted only if the issuer of the certificate certifies that the copy is identical to the original (official seal of the issuer is required).

\* If the certificate (original) is issued online by an overseas university office, a copy of the page and the URL of the official website of the issuing institution (university) must be attached to the certificate to confirm that the online certificate is equivalent to the original one.

\* For graduates of Chinese universities, substitution of the original English version of the Academic Credentials Verification Report issued by the 'China Higher education Information and Student Information Office (CHSI (Japan))' is acceptable. For those who have completed the 「自学考试 (本科)」 and obtained a degree, the original transcript and degree certificate issued by the institution conducting the 「自学考试」 must be submitted. Applications from applicants who have not yet completed 「自学考试」 are not accepted.

**(6) Degree Certificate**

Applicants who graduated or expected to graduate from a foreign university must submit a document (degree certificate) to certify that they have a degree equivalent to a bachelor's degree.

Applicants who have obtained a qualification for application from the National Institution for Academic Degrees and University Evaluation must submit a certificate of the degree awarded (a certificate of acceptance of application for the degree), an academic transcript, and other certificates related to earning the degree.

\* If the certificate (original) is issued online by an overseas university graduate office, a copy of the page and the URL of the official website of the issuing institution (university) must be attached to the certificate to confirm that the online certificate is equivalent to the original one.

**(7) Letter of Recommendation**

This should be obtained from your supervisor or homeroom teacher of your university (with affixed seal or signature.) If it is written in a language other than English, attach the English translation.

**(8) Documents to Prove English Proficiency**

You are required to submit an original copy of your TOEIC Official Score Certificate, TOEFL Examinee (Test Taker) Score Report (scores of the TOEFL iBT Home Edition test can be also accepted), or IELTS Academic Module Test Report Form. Scores on a test taken after August 2021 are valid.

Photocopies are not accepted.

Applicants eligible for an exemption from submitting TOEIC, TOEFL, or IELTS academic score requirements include the following:

- 1) Those whose first or native language is English.
- 2) Those from a country where English is an official language.
- 3) Those who completed undergraduate courses fully conducted in English.

If you fall under one of the above categories and wish to request this exemption, submit a letter that briefly summarizes your own linguistic background to support your request.

**(9) Letter of Approval for Entrance Examination**

Applicants who currently attend a university or graduate school (except those who are expected to graduate by August 2024) must submit a letter of approval for taking the entrance examination issued by the head of their university, or submit a written self-declaration stating that the applicant will withdraw from their current university before enrollment. (free format, A4 size)

Applicants who currently work for a government agency, school, or company (except for part-time workers) must submit a letter of approval for taking the entrance examination issued by the head of the institute (or department). Applicants who plan to leave their company to enroll in the graduate school may submit a written self-declaration stating that the applicant will withdraw from the company before enrollment as a substitute for the letter of approval.

**(10) Certificate of Government-Sponsored (Japanese Government *Monbukagakusho* Scholarship) Foreign Student**

If you are enrolled in another university at the time of application, submit a Certificate of Government-Sponsored (Japanese Government *Monbukagakusho* Scholarship) Foreign Student issued by the university.

**(11) Self-Declaration on Specific Categories for Security Export Control (Official Form)**

All applicants should submit this form.

**(12) Application Form for Online Entrance Examination (Official Form)**

Submit this form if you reside abroad at the time of application.

\*In principle, documents submitted in support of your application will not be returned to you.

\*If your current name is different from that on submitted certificates (for example, because of marriage), submit a copy of the relevant section of your family register/official records. If you wish to use your maiden name for student registration after enrollment, you may proceed with necessary procedures during admission.

\* Erroneous or suspect scores on any submitted score sheet will be confirmed with the issuer.

**7. Application Procedure**

Submit originals of all required certificates and supporting documents by simplified registered mail or at the GIP-TRIAD Office before the application deadline.

Application submission period: July 7, 2023 – July 21, 2023

Registered mail must arrive at the GIP-TRIAD Office by July 21. If submitting the application documents at the GIP-TRIAD Office, bring them by 17:00 (Japan Standard Time) on July 21.

Where to submit: GIP-TRIAD Office (International Joint Degree Master's Program in Agro-Biomedical Science in Food and Health) (see below, **13. Contact Us**).

**8. Screening Criteria**

Screening of documents will proceed based on the documents mentioned in “**6. Documents to be Submitted.**”

The oral examination in English will be conducted on August 25, 2023.

(In the case of many applications, we will conduct another examination on August 28, 2023.)

\*The oral examination will be conducted online for applicants who reside abroad. Such applicants must submit the Application Form for Online Entrance Examination within the application period.

#### Screening Method and Criteria

Application Document Screening (100 points)	Oral Examination (200 points)		
Aptitude Screening Based on the Application Documents	Group Discussion (100 points)	90 minutes	Debate on global issues related to “Food and Health”
	Presentation and Q&A session (100 points)	10 minutes	Presentation of motivation and research plans
		20 minutes	Q&A session on contents of the presentation and basic knowledge that will be required on this program

For the presentation, prepare your slides in PowerPoint (slides must have a white background). The slides must be converted into a PDF file and both PowerPoint and PDF files must be sent to [gip\\_info@un.tsukuba.ac.jp](mailto:gip_info@un.tsukuba.ac.jp) before 17:00 (Japan Standard Time) on August 18, 2023. On the examination day, bring your USB memory stick in which your presentation documents are saved.

#### 9. Testing Location

University of Tsukuba (1-1-1 Tennodai, Tsukuba, Ibaraki 305-8575, Japan)

For details of the date and meeting place, refer to the “Information and Instructions for Examinees” that will be sent after the application deadline.

#### 10. Applicants in Need of Assistance

If you need assistance because of a disability, contact the Office of the International Joint Degree Master’s Program in Agro-Biomedical Science in Food and Health by July 3, 2023 (see below, **13. Contact Us**).

#### 11. Announcement of Acceptance

September 14, 2023

Successful applicants will be notified about further procedures via email.

Please understand that we cannot respond to any inquiries regarding examination results.

#### 12. Enrollment Procedure

Follow the directions in the Enrollment Procedure Guidelines which will be sent out to successful applicants.

Expenses Required Upon Entrance

(1) Entrance fees: JPY 282,000

(2) Yearly tuition: JPY 535,800

Academic year 2024 (September 2024 – March 2025): JPY 312,550

\* Government-sponsored (Japanese Government *Monbukagakusho* Scholarship) foreign students are exempted from paying the entrance fees.

\* The students of this program will rotate through the University of Tsukuba, University of Bordeaux,

and National Taiwan University to spend a semester studying at each university. Students who have entered the University of Tsukuba through this examination will not be required to pay tuition or entrance fees to the University of Bordeaux or National Taiwan University.

Expenses that need to be paid after enrollment include costs related to visa applications, travel expenses to France and Taiwan, living expenses, and insurance fees. In addition, costs related to any necessary infection control measures, such as pre-departure PCR examination fees and/or accommodation expenses during the required quarantine period, are to be borne by students.

#### Other Notes

Individuals with nationalities other than Japanese must follow the Immigration Control and Refugee Recognition Act and be qualified for a resident status to enter graduate school before proceeding to the enrollment procedures. Individuals who wish to enroll in the university as a foreign exchange student must qualify for a “Student” resident status.

### 13. Contact Us

International Joint Degree Master’s Program in Agro-Biomedical Science in Food and Health  
(GIP-TRIAD) Office, University of Tsukuba  
1-1-1 Tennodai, Tsukuba, Ibaraki 305-8575, Japan  
Tel: +81-(0)-29-853-3228  
E-mail: [gip\\_info@un.tsukuba.ac.jp](mailto:gip_info@un.tsukuba.ac.jp)  
Opening Hours: 8:30-12:15 and 13:15-17:15

### 14. Disclosure of Entrance Examination Results

Entrance examination results will be disclosed only to unsuccessful applicants who have taken the GIP-TRIAD entrance examination.

- |                       |   |
|-----------------------|---|
| 1. Results disclosed  | Total entrance examination score of the unsuccessful applicant  |
| 2. Applicant          | Examinee who took the entrance examination  |
| 3. How to request     | <p>Print the Request Form for Disclosure of Admission Information on A4-size paper. Send the following required materials by post:</p> <ol style="list-style-type: none"> <li>1) Completed Request Form</li> <li>2) Reference Card (<i>Jukenhyo</i>) It will be returned when the disclosed information is sent by post.<br/>(In case you lost your Reference Card, submit proof of identity, such as a copy of your Student ID card or driver’s license.)</li> <li>3) A return envelope with the applicant’s name, complete address with postal code, and stamps in the amount of 434 JPY.<br/>If you reside abroad, please contact the below by email.</li> </ol> |
| 4. Application period | May 1~ May 31, 2024   |
| 5. How to disclose    | After the application period, the disclosed information will be sent to the examinee in the return envelope by registered mail.   |
| 6. For inquiries      | <p>1-1-1 Tennodai, Tsukuba, Ibaraki, Japan 305-8577<br/>Division of Admission, Department of Educational Promotion,<br/>University of Tsukuba<br/>E-mail: <a href="mailto:dai.daigakuinka@un.tsukuba.ac.jp">dai.daigakuinka@un.tsukuba.ac.jp</a></p>  |

### 【Research Supervisors for International Joint Degree Master's Program in Agro-Biomedical Science in Food and Health】

Name	Position and Affiliation	Email	Research Area	Research
Masao ICHIKAWA	Professor, Faculty of Medicine	masao@md.tsukuba.ac.jp	Global Public Health	<ol style="list-style-type: none"> <li>1. Global health research</li> <li>2. Community design &amp; health</li> <li>3. Injury prevention &amp; control</li> </ol>
Osamu OHNEDA	Professor, Faculty of Medicine	oohneda@md.tsukuba.ac.jp	Regenerative Medicine and Stem Cell Biology	<ol style="list-style-type: none"> <li>1. Analysis of differentiation and proliferation mechanisms of human mesenchymal stem cells (MSC)</li> <li>2. Development of clinical therapies using MSC</li> <li>3. Analysis of the effects of aging and disease on MSC function</li> </ol>
Koichi HASHIMOTO	Professor, Faculty of Medicine	koichi.hashimoto@md.tsukuba.ac.jp	Clinical and Translational Research Methodology	<ol style="list-style-type: none"> <li>1. Development of functional foods to increase immune function, prevent lifestyle-related diseases, etc.</li> <li>2. Development of new medical devices, e.g., for digital health</li> <li>3. Construction of seamless platforms for translational research</li> <li>4. Education of experts of the integrative celerity research process for translational researches</li> </ol>
Kazuya MORIKAWA	Professor, Faculty of Medicine	morikawa.kazuya.ga@u.tsukuba.ac.jp	Infection Biology (Bacteriology)	<ol style="list-style-type: none"> <li>1. Control of infection strategies in human pathogens</li> <li>2. Antimicrobial resistance</li> </ol>
Ryosuke OHNIWA	Associate Professor, Faculty of Medicine	ohniwa@md.tsukuba.ac.jp	Integrated Study on Health Information	<ol style="list-style-type: none"> <li>1. Science communication in food and health issues</li> <li>2. Prototype development of foodstuffs</li> <li>3. Science, technology, and society in food and health issues</li> <li>4. Development of methodology (science and East Asian traditional philosophy)</li> </ol>
Norihiko OHBAYASHI	Associate Professor, Faculty of Medicine	nohbayashi@md.tsukuba.ac.jp	Cellular and Physiological Biology	<ol style="list-style-type: none"> <li>1. Analysis of membrane trafficking mechanisms in mammalian cells</li> <li>2. Analysis of melanocyte activation mechanisms</li> </ol>
Tadachika KOGANEZAWA	Associate Professor, Faculty of Medicine	t-kogane@md.tsukuba.ac.jp	Neurophysiology	<ol style="list-style-type: none"> <li>1. The neural regulation of the cardiovascular system</li> <li>2. The neural regulation of the respiratory system</li> <li>3. Neural regulation-based cardiovascular and respiratory diseases</li> </ol>



Fabien LOMBARDO	Assistant Professor, Faculty of Life and Environmental Sciences	lombardo.renaud.gf@u.tsukuba.ac.jp	Plant Molecular Biology	1. Plant physiology and study of fruit development 2. Improvement of plant breeding traits using molecular technologies
-----------------	--	------------------------------------	-------------------------------	--

\* No faculty members are scheduled to retire until March 2025.



### **Payment of Examination Fees**

The applicant should pay the examination fee before submitting application documents. The University accepts either online credit card payments for both domestic and overseas applicants or convenience store payments for domestic applicants only.

**【Examination fee】** JPY 30,000

(Applicants who have received or will receive a MEXT scholarship are exempted from paying the fees.)

**【Payment Period】** July 7, 2023 (Friday) - July 21, 2023 (Friday)

**【Payment Method】**

**① Payment by credit card (VISA, MasterCard, JCB, AMERICAN EXPRESS)**

E-payment service - e-shiharai.net (in Japanese) or - e-shiharai.net - (in English)

Please pay by credit card using the URL above. After payment, access "Inquiry (申込内容照会)" at E-payment Service (URL above), print out the Certificate of Payment (収納証明書), then cut and affix the indicated portion of the Certificate of Payment to column "8" on the Application Form. Submit together with other required documents to the University.

**② Payment at convenience stores (Lawson, Seven-Eleven, FamilyMart, Mini stop)**

E-payment service - e-shiharai.net (in Japanese)

Please pay at a convenience store using the URL above. After payment, take the "Application Fee Statement" and cut out the "Certificate of Payment" part, affix it to column "8" on the Application Form. Submit it to the University together with other required documents.  
Please note that the payment fees should be paid by the applicant.

\*If the "Certificate of Payment" or the proof of payment is not affixed in the designated space of the Application Form, the application documents will not be accepted.

**For inquiries regarding payment of the examination fee,  
please contact:**

GIP-TRIAD Office, University of Tsukuba  
(Room 610, Building 4E, Medical Area, University of Tsukuba)  
Phone: 029-853-3228  
Email: [gip\\_info@un.tsukuba.ac.jp](mailto:gip_info@un.tsukuba.ac.jp)

# University of Tsukuba

## How to make Payment of Examination Fee at Convenience Store or by Credit Card

Now you can transfer funds to pay for your entrance examination - 24 hours a day - from your nearest Lawson, Ministop, FamilyMart, Seven-Eleven, store or Credit Card.

### 1 Advance Web Application

Visit the payment site homepage from your computer or cell phone at:



**<https://e-shiharai.net/>**



※ You can not correct or cancel anything once your credit card payment has been made. Please check all your information carefully before you confirm the application.

※ If you input the wrong information when trying to obtain your application number, please start again from the beginning and make your payment.  
If you are not able to make the required payment before the due date you will receive this deadline upon completing the online application, all the information you had input will be canceled automatically.

### 2 Credit Card Payment

**VISA** **Mastercard** **JCB** **American Express**

It is possible to use a card which carries a name different from that of the applicant. However, please make sure that the information on the basic information page is the applicant's information.

Please select "credit card" for the payment method when making your Web application.

Input your card information.

All of your application information is displayed. Check and Click "確定".

Payment has been completed.  
Please write down "受付番号"  
Receipt Number  
Please print out your "収納証明書"  
Certificate of Payment

### Convenience Store Payment

The application fee cannot be paid through an ATM.  
Be sure to make your payment at the cash register.

**7 ELEVEN**

[13-digit Payment Slip Number]  
払込票番号

Tell the counter staff that you want to make an "Internet shiharai."  
Then provide your Payment  
【払込票番号】  
Payment Slip Number

A multifunction copier can not be used to make payment.

● Make the payment at the register.  
● Receive an Application Fee Statement. Detach the Certificate of Payment (receipt) portion.

**LAWSON** **MINI STOP**

[11-digit Customer Number]  
お客様番号  
[4-digit Verification Code]  
確認番号

Touch the "各種サービスメニュー" option  
Various Service Menus

Select the "各種代金・インターネット受付" button on the touch screen  
All Payments・Internet Reception

Touch the "各種代金お支払い" option  
All Payments

Touch "マルチペイメントサービス"  
Multi-Payment Service

Enter your  
【お客様番号】【確認番号】  
Customer Number Verification Code

● Loppi, FamiPort, issues a funds transfer receipt.  
You will need to take this to the cash register within 30 minutes and make the actual payment.  
● Receive an Application Fee Statement. Detach the Certificate of Payment (receipt) portion.

**FamilyMart**

[11-digit Customer Number]  
お客様番号  
[4-digit Verification Code]  
確認番号

Select the "代金支払い" button on the touch screen  
All Payments

Touch the "各種代金お支払い" option  
All Payments

"番号入力画面に進む"  
Advance to the "Entering number" page

Enter your  
【お客様番号】【確認番号】  
Customer Number Verification Code

● Loppi, FamiPort, issues a funds transfer receipt.  
You will need to take this to the cash register within 30 minutes and make the actual payment.  
● Receive an Application Fee Statement. Detach the Certificate of Payment (receipt) portion.

### 3 Application

#### [Paying by Credit Card]

After making your payment, please make sure you have access to a printer with paper(A4).  
Access "申込内容照会"(Inquiry) at e-shiharai.net.

Please 「1. Check your card.」「2. Input Receipt Number.」「3. Input your Birth Date.(YYYY/MM/DD)」, and click "照会する".

Then all of your application information is displayed.  
Click Blue-button "証明書を発行する".  
Affix the cutting portion of "収納証明書"(The Certificate of Payment) in the designated location.  
Enclose in an envelope with all other necessary application documents.

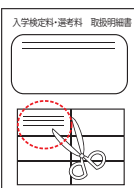

In the case that you have made your payment using a credit card, it is not necessary to enclose a bank receipt of any kind.

#### [Paying at Convenience Store]

Affix the receipt portion to "The Certificate of Payment" in the designated location.



Attach Your (Certificate of Payment) to the Application

※ When attaching the certificate of payment, be sure to use glue which is suitable for use with thermal paper and pressure-sensitive paper. Please check the glue label.

※ In the case that you have made your payment at Convenience Store, it is not necessary to enclose a bank receipt of any kind.

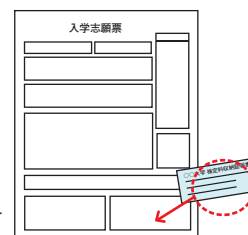

- During payment periods and application periods mentioned in the application documents, you can make a payment anytime. Please confirm from application documents and complete payment in time for the application period.
- On the last date of the payment period, the web application will be closed at 11pm, and the final deadline for the information terminal at convenience stores (Loppi, Fami Port, ) will be at 11:30pm.
- Your inquiry about the payment of "the entrance examination fee" is not able to be handled at the convenience store. For further information, please check our website.
- Please note that refund is not possible once you have made a payment of Entrance examination fee.

- A fee is added to Examination fee. For further info, please visit our website.
- Please directly contact the credit card company if your card is not accepted.
- It will be announced on our website if either the convenience stores which handle payments or the methods of payment are changed.